



⚠ ATTENZIONE

Si raccomanda di rivolgersi a un elettricista qualificato per installare il prodotto.

Si raccomanda di non toccare il prodotto quando è acceso.

In caso di malfunzionamento, staccare la lampada dall'alimentazione.

Si raccomanda di rivolgersi a un elettricista e di non provare a riparare la lampada da soli.

MANUALE D'ISTRUZIONI

PLAFONIERA 3CCT IP54

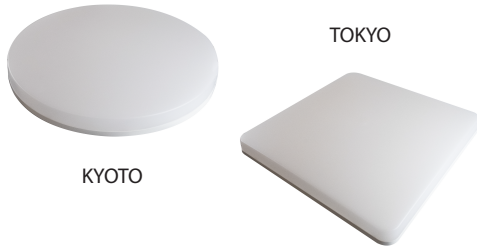

Specifiche tecniche:

	MISURE	W	Lumen	AC/Hz	3CCT (SWITCH)	CRI	α	TEMP LAVORO	DURATA	FLICKER	DIMM.	CLASSE	IK
IP18RBS	Ø200*53mm	18	2000	AC180-250V Hz 50/60	3000/4000/6500K	80	120°	-20°+50°	25000 H	FREE	NO	II	06
IP28RBS	Ø250*53mm	28	3000	AC180-250V Hz 50/60	3000/4000/6500K	80	120°	-20°+50°	25000 H	FREE	NO	II	06
IP42RBS	Ø330*53mm	42	4500	AC180-250V Hz 50/60	3000/4000/6500K	80	120°	-20°+50°	25000 H	FREE	NO	II	06
IP54RBS	Ø400*53mm	54	5800	AC180-250V Hz 50/60	3000/4000/6500K	80	120°	-20°+50°	25000 H	FREE	NO	II	06
IP18QBS	200*200*53mm	18	2000	AC180-250V Hz 50/60	3000/4000/6500K	80	120°	-20°+50°	25000 H	FREE	NO	II	06
IP28QBS	250*250*53mm	28	3000	AC180-250V Hz 50/60	3000/4000/6500K	80	120°	-20°+50°	25000 H	FREE	NO	II	06
IP42QBS	330*330*53mm	42	4500	AC180-250V Hz 50/60	3000/4000/6500K	80	120°	-20°+50°	25000 H	FREE	NO	II	06
IP54QBS	400*400*53mm	54	5800	AC180-250V Hz 50/60	3000/4000/6500K	80	120°	-20°+50°	25000 H	FREE	NO	II	06

Plafoniere a LED rotonde e quadrate installabili facilmente a parete/soffitto. Corpo e diffusore V2 autoestingente e Anti-UV in policarbonato termoplastico e staffa in lega di alluminio. Resistente agli urti.

1

MONTAGGIO

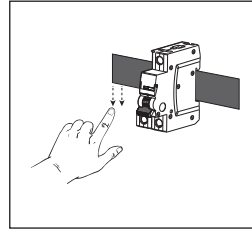

1. Scollegare la corrente elettrica.

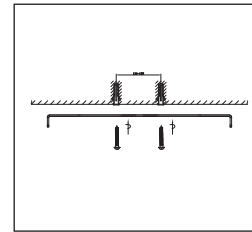

2. Effettuare i fori sul muro in base alla posizione del foro della staffa, posizionare la vite di espansione.

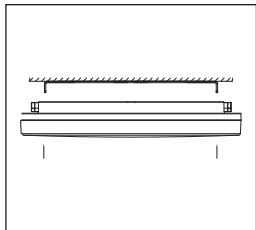

3. Scegliere la temperatura di utilizzo, connettere il cavo all'alimentazione e fissare la lampada alla staffa.

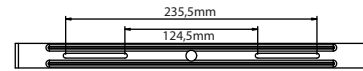

IP42RBS/QBS
IP54RBS/QBS

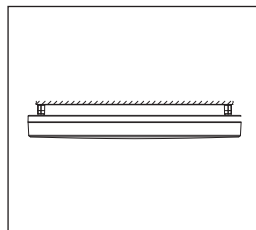

4. Accendere l'alimentazione dopo aver installato la lampada.

Informazioni sul riciclaggio in conformità con le direttive RAAE e batterie



Simbolo sul prodotto



Simbolo sulla batteria

Solo Europa

Il prodotto/batteria è contrassegnato con uno dei simboli di riciclaggio sopra indicati. Questo indica che a fine vita il prodotto/batteria, dovrà essere smaltito/a separatamente in appropriati luoghi di raccolta e non con i normali rifiuti domestici.

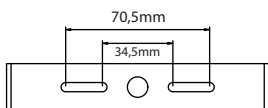

IP18RBS/QBS

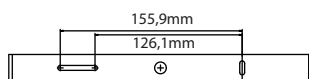

IP28RBS/QBS

CE RoHs

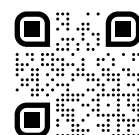

IPERLUX®
www.iperlux.com
info@iperlux.com

INSTRUCTION MANUAL CCT LED CEILING LAMP IP54

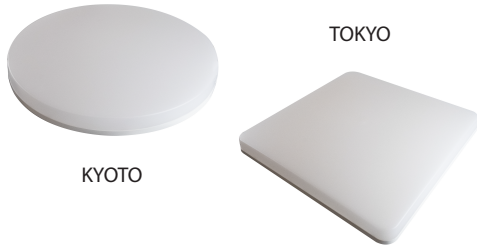

It is recommended to contact a qualified electrician to install the product.

It is recommended not to touch the product when it is turned on.

In case of malfunction, disconnect the lamp from the power supply. It is recommended to contact an electrician and not try to repair the lamp yourself.

MOUNTING

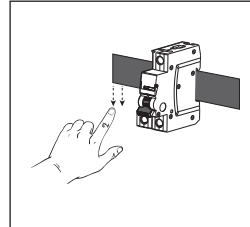

1. Switch off the power.

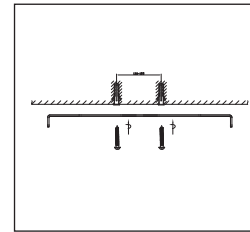

2. Trepanning on the wall according to the bracket hole position, put the expansion screw.

Specifications and Technical Data sheet:

	SIZE	W	Lumen	AC/Hz	3CCT (SWITCH)	CRI	α	AMB. TEMP.	LIFETIME	FLICKER	DIMM.	CLASS	IK
IP18RBS	Ø200*53mm	18	2000	AC180-250V Hz 50/60	3000/4000/6500K	80	120°	-20°+50°	25000 H	FREE	NO	II	06
IP28RBS	Ø250*53mm	28	3000	AC180-250V Hz 50/60	3000/4000/6500K	80	120°	-20°+50°	25000 H	FREE	NO	II	06
IP42RBS	Ø330*53mm	42	4500	AC180-250V Hz 50/60	3000/4000/6500K	80	120°	-20°+50°	25000 H	FREE	NO	II	06
IP54RBS	Ø400*53mm	54	5800	AC180-250V Hz 50/60	3000/4000/6500K	80	120°	-20°+50°	25000 H	FREE	NO	II	06
IP18QBS	200*200*53mm	18	2000	AC180-250V Hz 50/60	3000/4000/6500K	80	120°	-20°+50°	25000 H	FREE	NO	II	06
IP28QBS	250*250*53mm	28	3000	AC180-250V Hz 50/60	3000/4000/6500K	80	120°	-20°+50°	25000 H	FREE	NO	II	06
IP42QBS	330*330*53mm	42	4500	AC180-250V Hz 50/60	3000/4000/6500K	80	120°	-20°+50°	25000 H	FREE	NO	II	06
IP54QBS	400*400*53mm	54	5800	AC180-250V Hz 50/60	3000/4000/6500K	80	120°	-20°+50°	25000 H	FREE	NO	II	06

LED ceiling lamps round and square, easy to install on the wall or ceiling. ANTI-UV and V2 Self-extinguishing thermoplastic PC housing and diffusor and aluminium alloy bracket. Resistant to impacts.

1

2

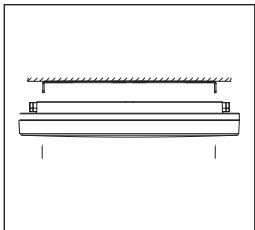

3. Choose the CCT temperature, connect the input wire to the product wire, reconnect metal bracket with fitting.

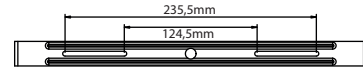

IP42RBS/QBS
IP54RBS/QBS

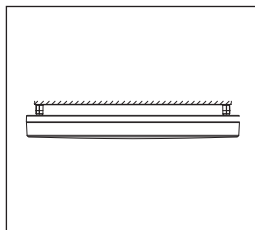

4. Switch on the power after installing the product.

Recycling Information in Accordance with the WEEE and Battery Directives



Product Mark



Battery Mark

Europe only

The product/battery is marked with one of the above recycling symbols. It indicates that at the end of the life of the product/battery, you should dispose of it separately at an appropriate collection point and not place it in normal domestic waste stream.

CE RoHS

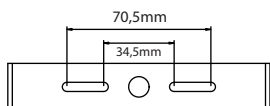

IP18RBS/QBS

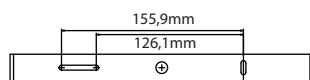

IP28RBS/QBS

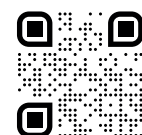

IPERLUX®
www.iperlux.com
info@iperlux.com